

PLEASE READ CAREFULLY BEFORE SETTING UP YOUR DISPLAY!

# xpressions

AVOID DAMAGE TO YOUR DISPLAY, USE PROPER SET-UP PROCEDURE.

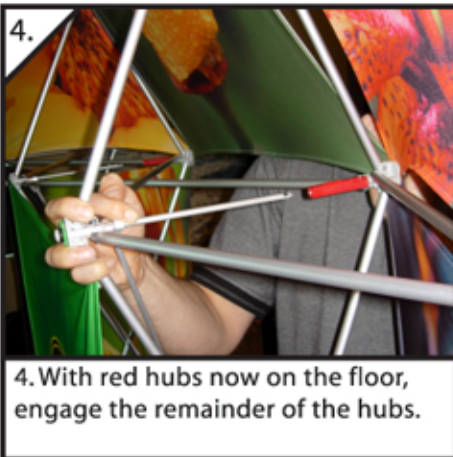
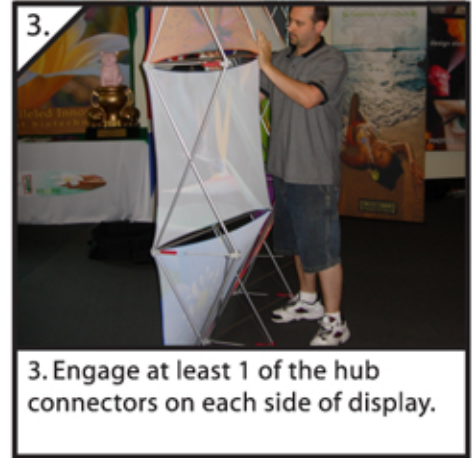

**Important!** Before and during set-up make sure skins are not twisted or caught on connectors or hubs, (see figure 1) if you feel tension stop! Check for snags and begin again (see figure 2).



**NOT Like This**  
NOTICE ALL FOUR CORNERS AND CENTER GRAPHIC ARE WRONG!

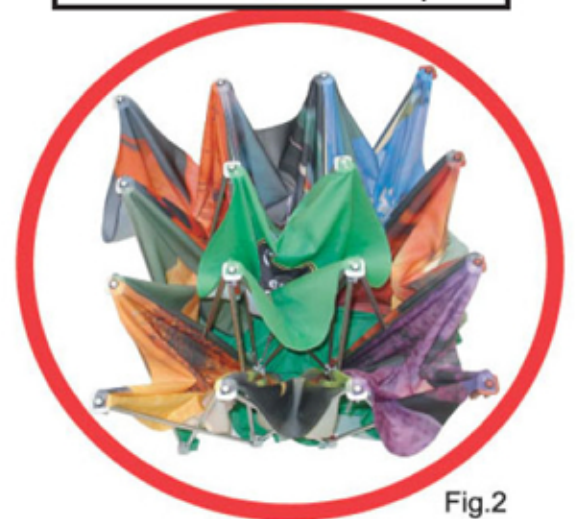

**Like This**